



**Note: These items are not included in this package.**

1. Mainboard
2. Hard disk
3. RAM
4. Optical drive
5. CF reader

**Size: 298.8 x 228.8 x 72.8 mm**

### 1. Summary

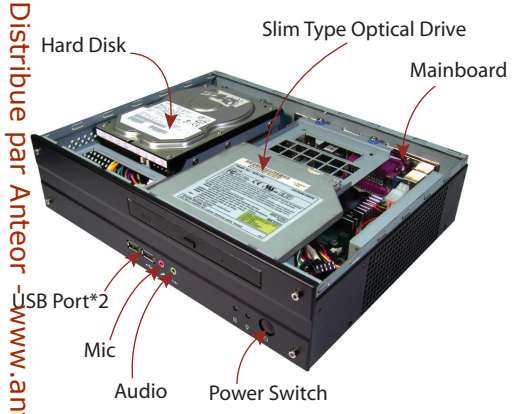

### 3a. Install 3.5" HDD

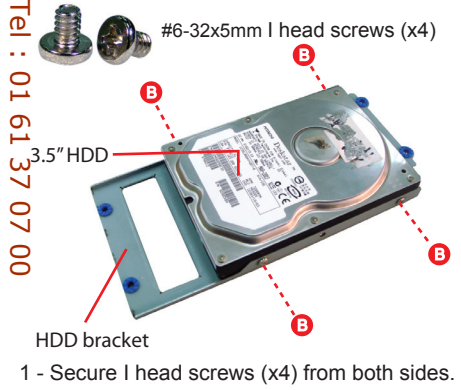

### 2. Install Mainboard

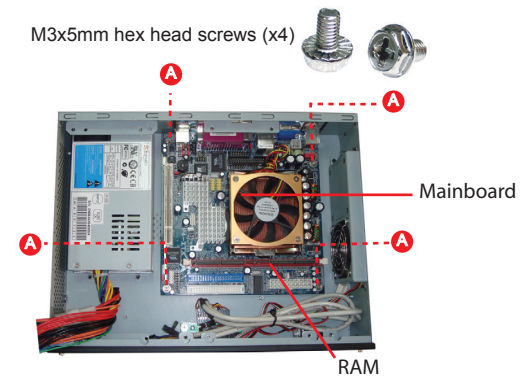

### 3b. Install 2.5" HDD

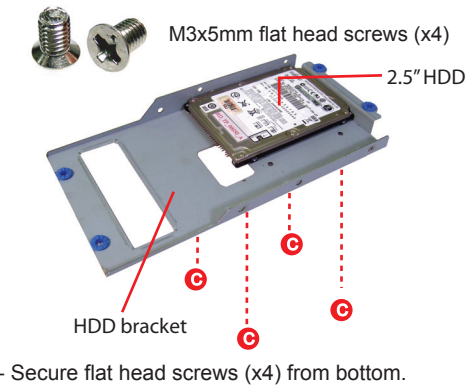

### 4. Install HDD Bracket

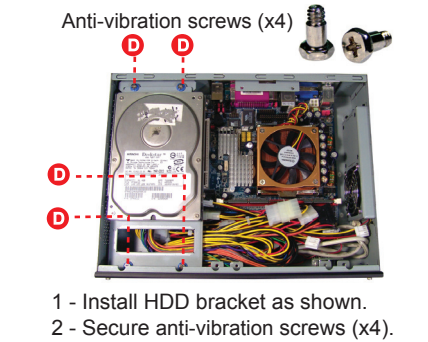

### 6. Install optical drive bracket

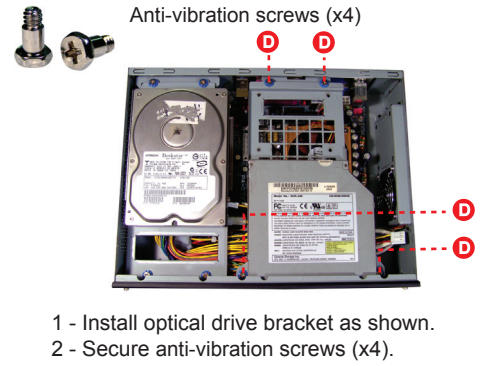

### 8. Install CD\_ROM Cover

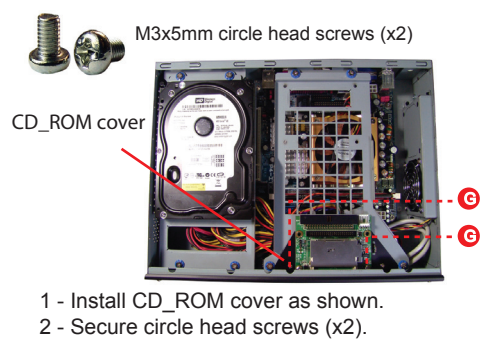

### Safety Cautions

- SAFETY STEPS:** When removing the chassis cover to access the system components, follow the safety precautions below:
1. Turn off all peripheral devices connected to the system.
  2. Turn off the system by pressing the power button.
  3. Unplug all AC power cords from the system or from wall outlets.
  4. Label and disconnect all cables connected to I/O connectors or ports on the back of the system.
  5. Wear an antistatic wrist strap grounded to the chassis -- any unpainted metal surface -- when handling components.
  6. Do not turn on the system when the chassis cover is open.

### 5. Install Slim Type Optical Drive

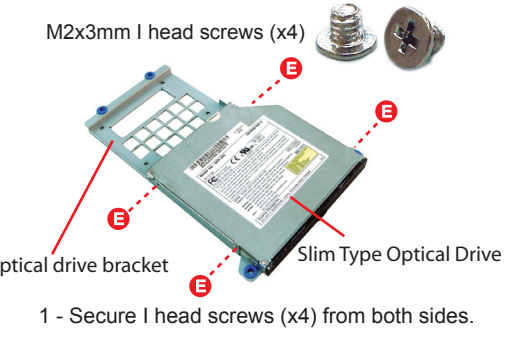

### 7. Install CF reader (optional)

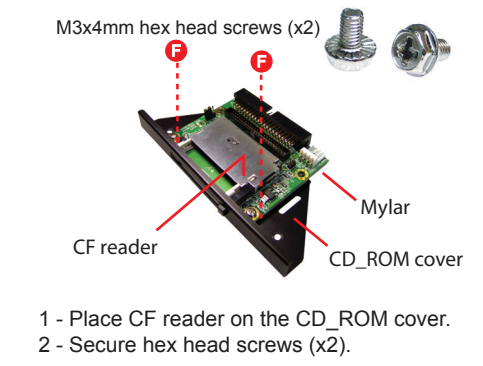

### 9. Close Top Cover

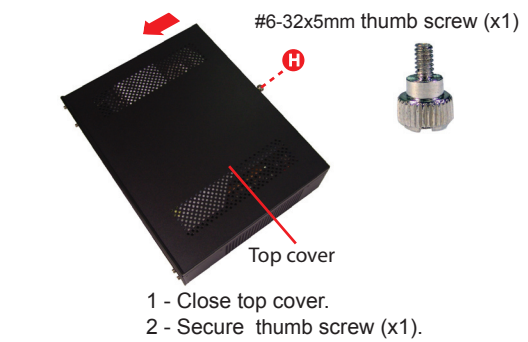

Distribue par Anteor - www.anteor.co Tel : 01 61 37 07 00