

LPC-185W

18.5" Panel PC with Intel Braswell Celeron® N3160, IP65 Front Bezel and Wide Range Power



Full HD

Features

- ▶ Intel® Celeron® N3160 Quad Core 1.6GHz
- ▶ IP65 Compliant Front Bezel
- ▶ Fanless Design
- ▶ 3-Pin Power Input Terminal Block
- ▶ DC 9~36V Wide Range Power Input
- ▶ Resistive Touch Screen
- ▶ 1920*1080 Resolution
- ▶ 350 nits LED Backlight
- ▶ 1000 nits LED Backlight (Optional)



Product Overview

Incorporated LCD panel with resolutions up to 1920*1080 LED backlight brightness, motherboard for versatile industrial applications, LPC-185W is fanless Panel PC based on Intel® Celeron® N3160 SoC processor. The touch screen provides the durable, reliable, and scratch-able benefits for easy maintenance in wide applications, especially for food, beverage, factory, automation and traffic control.

Specification

System	
Processor	Intel® Celeron® N3160 SoC CPU
System Memory	SO-DIMM, up to 8 GB
External I/O Port	4 x USB 3.0 2 x GbE LAN (RTL8111G) 1 x Display Port 1 x HDMI 3 x RS-232 1 x RS-232/422/485 1 x Audio 1 x Power press button 1 x 3-Pin Power Input
Storage	1 x SATA3 (6.0Gb/s) 1 x mSATA (full size mini-PCIe)
Operating System	Windows 7 Pro, Windows Embedded Standard 7, Windows 8, Windows 10

LCD	
Display Type	18.5" TFT-LCD
Max. Resolution	1920*1080
Max. Color	16.7 M
Luminance	350 nits
View Angle	189 / 189
Backlight Lifetime	30,000 hours

Mechanical	
Construction	Metal
IP Rating	Front Bezel IP65
Mounting	Panel Mount VESA Mount 100x100
Dimension	465 x 295 x 59 mm

Power Requirement	
Power Type	3-Pin Power Input Terminal Block DC 9~36V Wide Range Power Input

Environment	
Operating Temp	0~55 °C
Storage Temp	-20~70 °C
Humidity	10~90% @40 °C, non-condensing
Certificate	CE / FCC Class A

Touch Screen	
Type	5 Wire Res with USB Interface

Dimension & I/O Connector

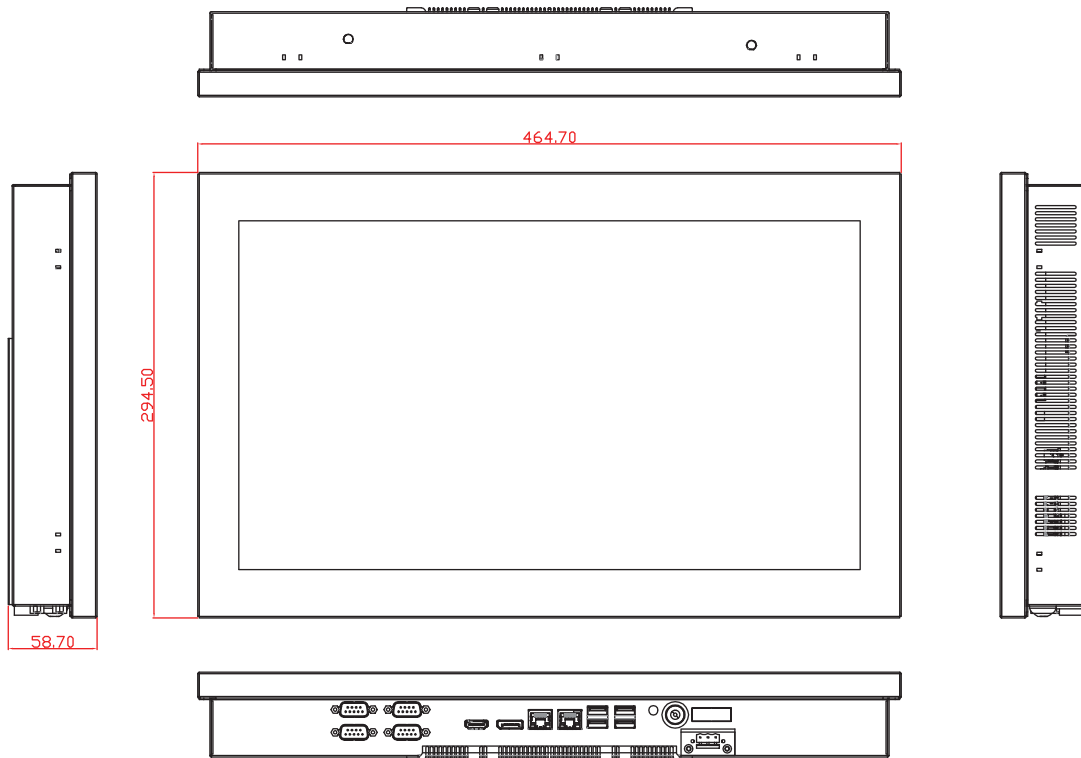

Mounting Kit

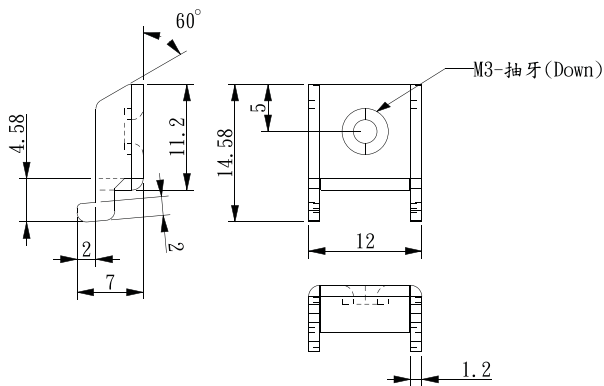

Ordering Information

TS1GSK64W6H	8 GB DDR3L 1600 SO-DIMM
TS32GSSD420K	32 GB SSD , SATA3, MLC
TS64GSSD420K	64 GB SSD , SATA3, MLC
TS128GSSD420K	128 GB SSD , SATA3, MLC
TS16GMSA370	16GB, mSATA SSD, SATA3, MLC
TS32GMSA370	32GB, mSATA SSD, SATA3, MLC
TS64GMSA370	64GB, mSATA SSD, SATA3, MLC

Ordering Information

LPC-185W	18.5" Panel PC, Intel® Celeron® N3160, 4 GB DDR3L, 1920 x 1080 Reso, 350 nits, 4 COM, 4 USB, 2 LAN, DC 9~36V with 3-pin Power Terminal Block
LPC-185WH	18.5" Panel PC, Intel® Celeron® N3160, 4 GB DDR3L, 1920 x 1080 Reso, 1000 nits, 4 COM, 4 USB, 2 LAN, DC 9~36V with 3-pin Power Terminal Block
WFK-024	Wi-Fi kits w/ cable & Antenna (2.4GHz, 802.11 b/g/n, 1T1R)
WFK-524	Wi-Fi kits w/ cable & Antenna (2.4 & 5GHz, 802.11 a/b/g/n/ac + BT, 2T2R)
04-US-26-00001	60 W / 12V power adapter with 3 pin terminal block
04-US-26-00002	120 W / 24V power adapter with 3 pin terminal block (For High Brightness Model)
PB-936	Power Board for Input on board fuse / Input reverse protection / Over current protection / Output short circuit protection